

INTEGRATORS OF CRYOGENIC SYSTEM SOLUTION

INTEGRATORS OF CRYOGENIC SYSTEM SOLUTION

立达恒

Provide professional low temperature solutions

Fully meet your low temperature system applications



日期：2024年3月12日

| 氮气系统 | 解决问题 集成商

| nitrogen system | Problem-solving Integrator



company profiles

Service tenet : high product quality, good product service

LDH GAS SYSTEMS COMPANY LIMITED, Gas equipment products include nitrogen making machine and oxygen making machine ; low temperature equipment includes liquid nitrogen machine, liquid nitrogen treatment chamber, high and low temperature testing machine, natural gas liquefaction equipment ; the environmental simulation equipment includes low oxygen and oxygen enrichment, high temperature and low temperature, ultraviolet light, wind, salt fog and other comprehensive environmental simulation. At the same time, system solutions can be customized according to user needs.



Closely cooperate with major scientific research structures



The products cover many industries, and the products are sold to the whole country and other countries.

company profiles



The company has a number of national patent certificates, computer soft certificate, and passed the EU CE certification and ISO9001 certification. The company focuses on scientific and technological innovation, cooperates with foreign counterparts, exchanges and cooperates with many domestic research institutions and universities.



Smart gas solutions inject unlimited power into your system



Professional low temperature system, excellent performance, to meet your stringent needs



Predict changes, control the future, environmental simulation system, accurate reproduction of thousands of scenes



Qualifications and Awards



01

corporate quality

02

quality certification

03

letter of patent

04

instrument of credit



制氮机原理

Principle of LN2 GENERATOR

The LDH liquid nitrogen machine is a device that can liquefy nitrogen in the air into liquid nitrogen through a deep refrigeration process. Nitrogen sources usually use pressure swing adsorption (PSA) or membrane separation techniques to separate nitrogen from other components such as oxygen in the air to obtain high-purity nitrogen.

Pressure swing adsorption (PSA) is an advanced gas separation technology, which has an irreplaceable position in the field of gas supply in the world today. Generally, PSA nitrogen production selects high-quality imported carbon molecular sieve (CMS) as an adsorbent, which adsorbs oxygen, carbon dioxide, water, etc.in the air, while nitrogen is not easily adsorbed.



GENERATOR Principle of N2

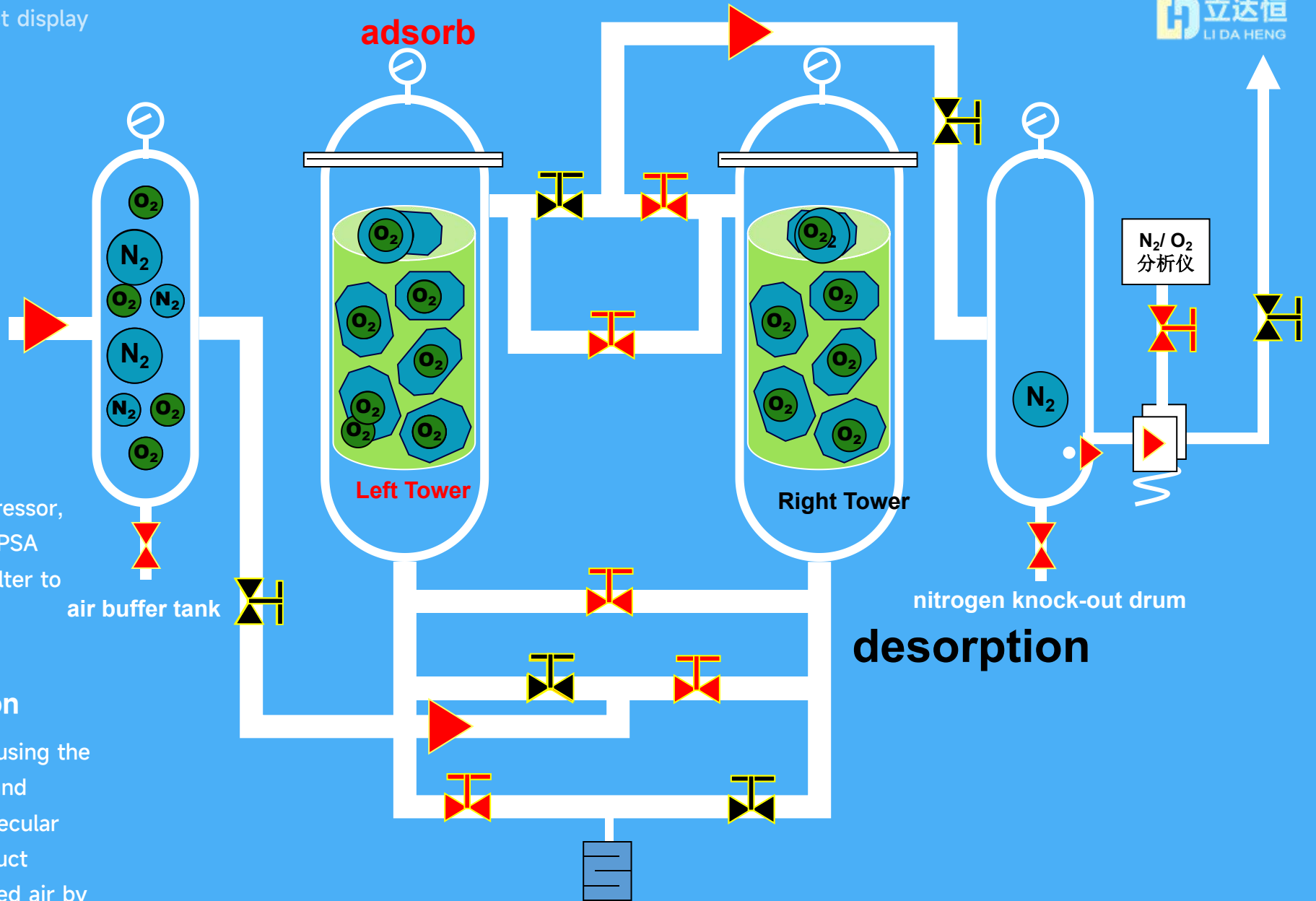

aseptic filtration

Compressed air through the screw air compressor, after cold dry suction dry filtration, into the PSA nitrogen machine, through the sterilization filter to generate dew point-60 °C sterile nitrogen.

Carbon molecular sieve adsorption

Using carbon molecular sieve as adsorbent, using the difference of adsorption amount of oxygen and nitrogen molecules in compressed air in molecular sieve, the gas separation equipment of product nitrogen is directly prepared from compressed air by the principle of pressurized adsorption and depressurization desorption.

Nitrogen refrigeration composition compression unit

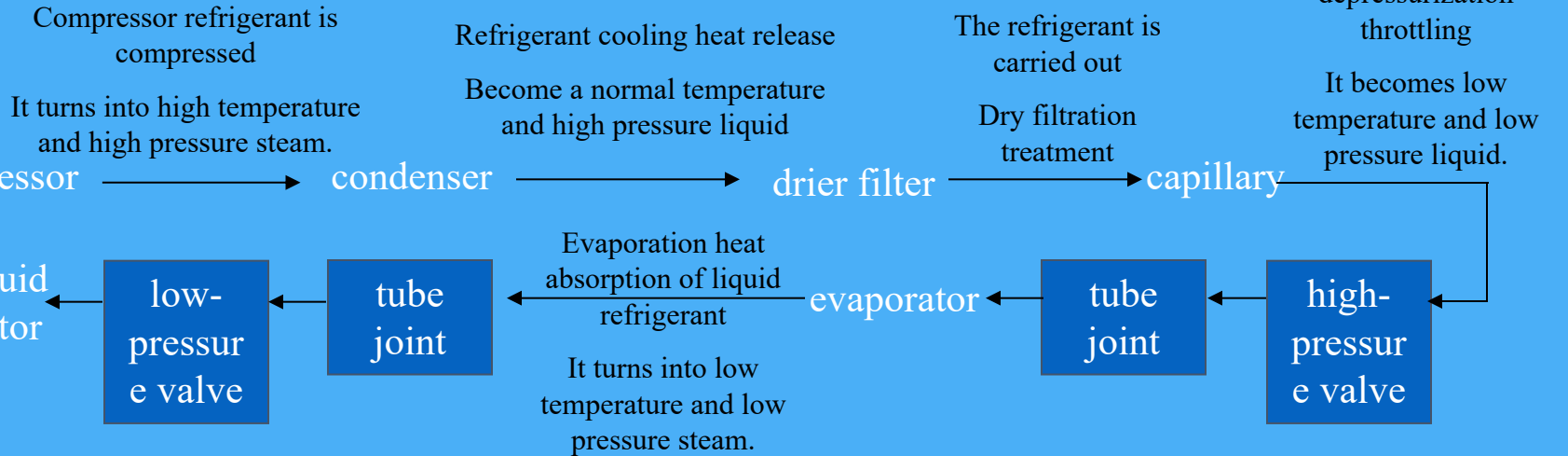
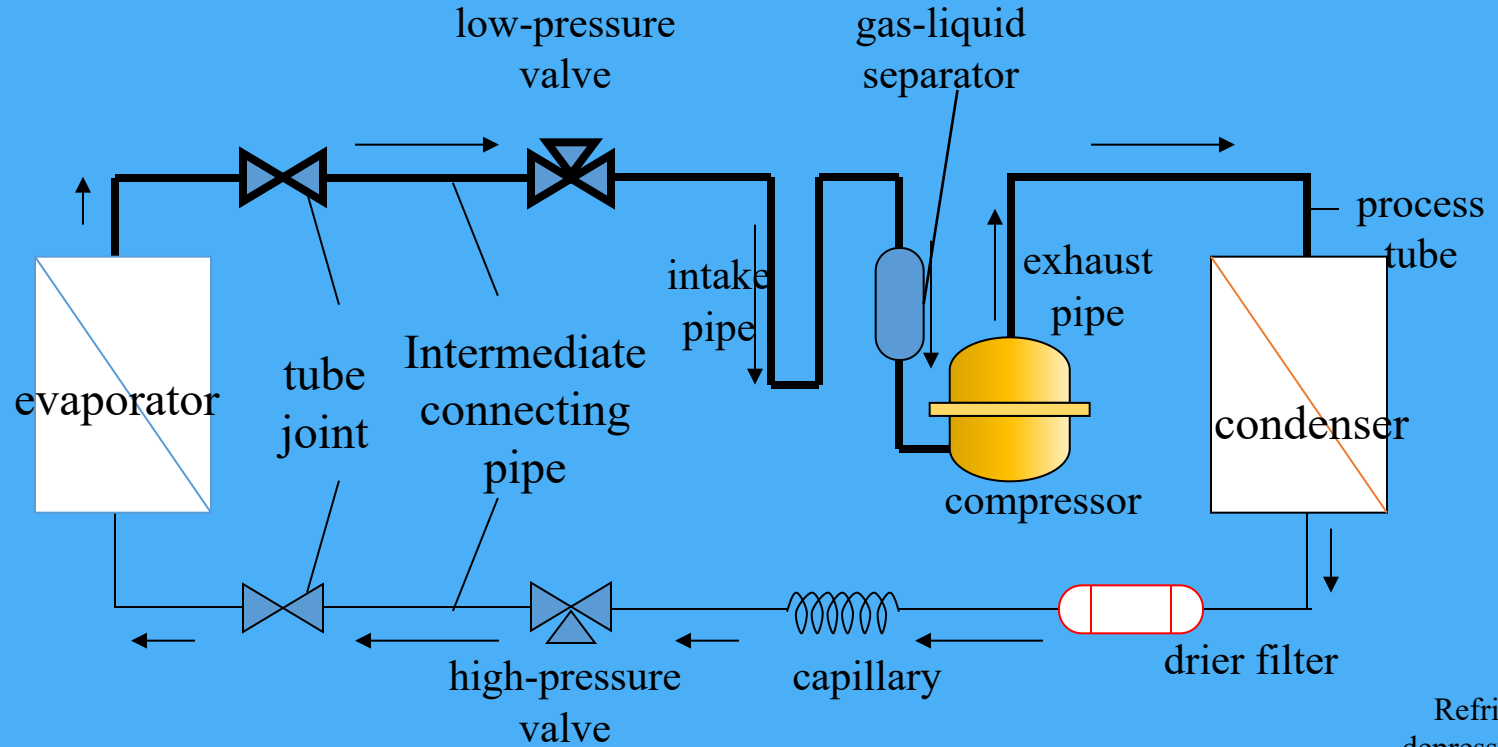

Integrated nitrogen generator



LPN-1.5
1.5m³/H



LPN-3
3m³/H



LPN-3
3m³/H

Split nitrogen generator



LPN-6
6m³/小时



LPN-16
16m³/小时

Introduction of some accessories



比恩测氧仪



比恩流量计



SMC流量计

Introduction of some accessories



气动阀门



空气过滤器

Some model parameters of nitrogen making machine



产气量 Capacity	纯度% Purity	型号 Model	长 (mm) length	宽 (mm) Width	高 (mm) Height	重量 (kg) Weight	进口尺寸 (DN) Inlet size	出口尺寸 (DN) Outlet size	缓冲罐容积 (m ³) Buffer tank volume
5	99	LPN-5H	1000	1000	1640	380	DN15	DN15	
	99.9	LPN-5I	1000	1000	1640	380	DN15	DN15	
	99.99	LPN-5J	1300	1100	1400	560	DN15	DN15	0.3
	99.999	LPN-5K	1300	1100	1400	560	DN15	DN15	0.3
20	99	LPN-20H	1450	1300	1450	700	DN20	DN15	0.3
	99.9	LPN-20I	1500	1400	2030	900	DN25	DN20	0.5
	99.99	LPN-20J	1500	1500	1700	1000	DN25	DN15	0.5
	99.999	LPN-20K	1600	1450	1950	1400	DN25	DN15	0.5
50	99	LPN-50H	1600	1400	2100	1100	DN25	DN20	0.5
	99.9	LPN-50I	1700	1500	2100	1300	DN25	DN15	0.5
	99.99	LPN-50J	1700	1550	2160	1500	DN40	DN25	0.5
	99.999	LPN-50K	2000	1800	2500	2300	DN40	DN40	0.5
100	99	LPN-100H	1600	900	2230	1050	DN40	DN50	1.5
	99.9	LPN-100I	1800	1750	2250	1400	DN40	DN25	1.5
	99.99	LPN-100J	2100	1950	2250	2700	DN40	DN40	1
	99.999	LPN-100K	2200	1300	2900	3300	DN65	DN40	2
150	99	LPN-150H	1800	1150	2200	1400	DN40	DN25	1.5
	99.9	LPN-150I	2100	1200	2250	2200	DN40	DN40	1.5
	99.99	LPN-150J	2200	1300	2700	3200	DN50	DN40	2
	99.999	LPN-150K	2200	1500	3100	4400	DN80	DN50	4
200	99	LPN-200H	2000	1150	2300	1700	DN40	DN25	2
	99.9	LPN-200I	2100	1200	2500	2200	DN40	DN50	2
	99.99	LPN-200J	2200	1400	2850	4100	DN65	DN50	2.5
	99.999	LPN-200K	2200	1500	3000	4100	DN65	DN50	4

Remote Control - Internet of Things

- With the camera, real-time monitoring of equipment production
- The super large wide angle lens at the upper position and the 10 times zoom lens at the lower position are used to realize the real no dead angle monitoring.

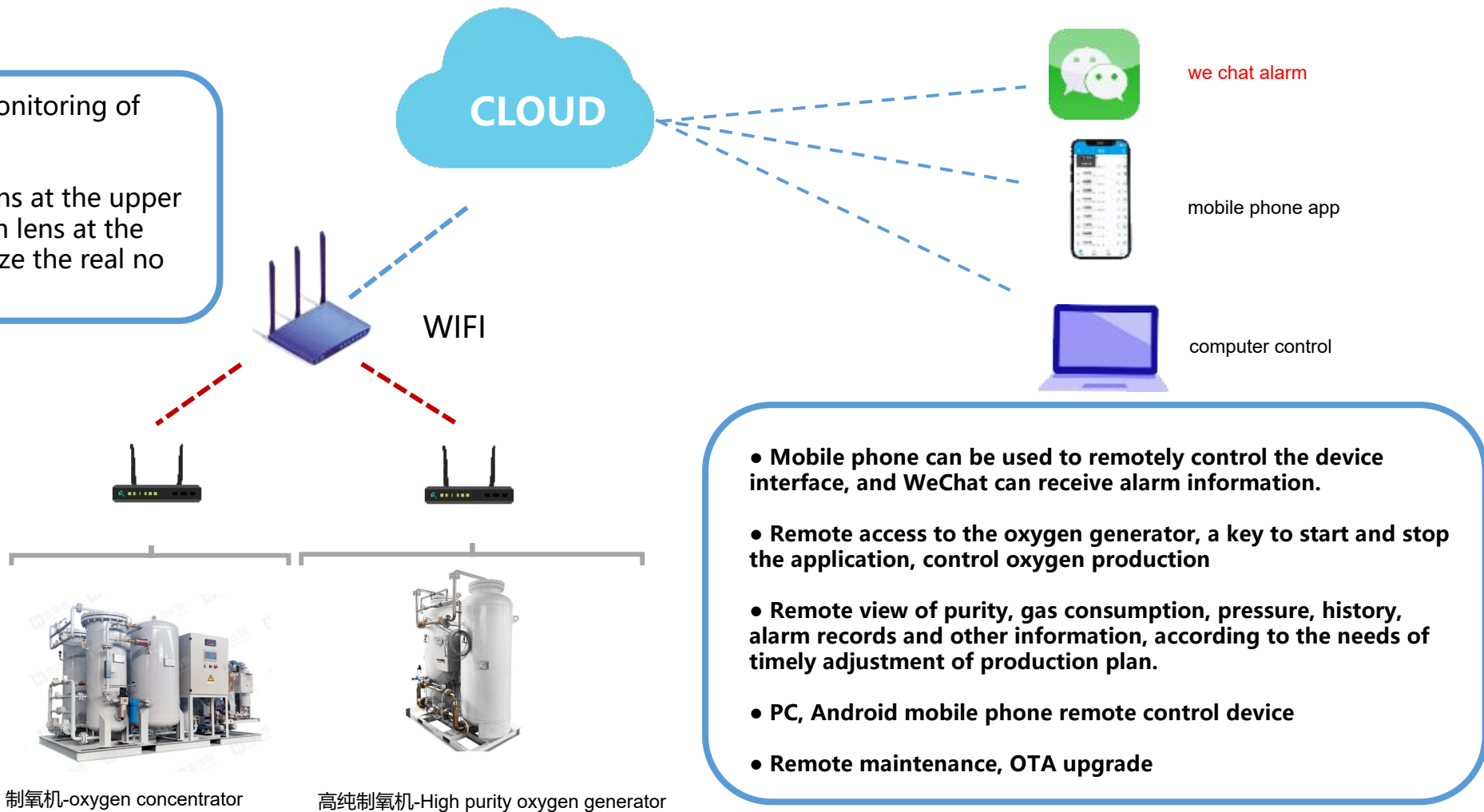

- Mobile phone can be used to remotely control the device interface, and WeChat can receive alarm information.
- Remote access to the oxygen generator, a key to start and stop the application, control oxygen production
- Remote view of purity, gas consumption, pressure, history, alarm records and other information, according to the needs of timely adjustment of production plan.
- PC, Android mobile phone remote control device
- Remote maintenance, OTA upgrade

Strict quality inspection process

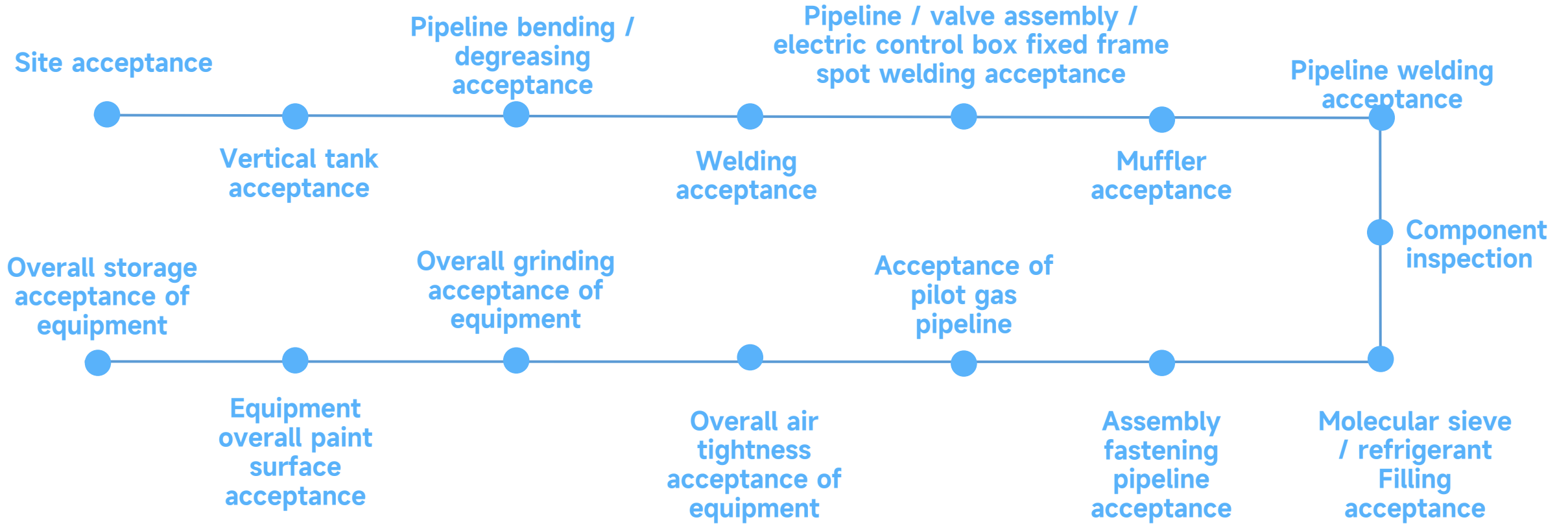

comprehensive quality management



Material inspection



examination of product



Preparing for delivery



IQC
Through supplier review and assessment, sign relevant quality agreements

IPQC
Regular training to enhance staff quality awareness and operational skills. Self-inspection, mutual inspection and special inspection in production

FQC
Technology, after-sales, production, quality control multi-sectoral joint inspection

OQC
The enterprise management department lists a detailed shipping list, based on the list of goods to be shipped.

service guarantee

Customer filing

Equipment to establish electronic files, paper files, archiving.



regular return visit

Technicians visit users at least once a year or by telephone.



Fault warranty

Free replacement of parts during the warranty period ; troubleshooting, quickly reach the scene within 24 hours.



technical consultation

7 * 24 hours round-the-clock telephone consultation.



application training

Operation training, use assessment.



24-hour service hotline

The customer service department set up a 24-hour service hotline to provide customers with technical advice and after-sales service. Tel : 010-86482980





quality assurance

Quality assurance through unremitting innovation, advancing with the times, the company continues to open up a new situation, to achieve a new leap.

We provide 7x24 hours of all-weather response speed, anytime, anywhere for you, so that the whole of China leading the response speed.

The company adheres to the 'people-oriented, the pursuit of transcendence' business philosophy; adhere to the 'integrity-based, customer first' for the purpose of service.



Pre-sales engineers provide professional solutions according to customer needs.



Provide customers with on-site start-up services to ensure that the technical indicators of the equipment meet the specified requirements of the customer.



After-sales engineers regularly carry out customer return visits, track, investigate the operation of equipment, and provide technical advice.



Free maintenance service and spare parts service are provided for the equipment during the warranty period.

after-sale service



service items	service profiles	execution time	explanation
telephony support	all weather	instant	7*24小时 010-86482980
Email support	Monday to Friday	Within 4 hours	market@bj-ldh.com
online support	Monday to Friday	instant	Website online support
application training	After installation and debugging	instant	Training assessment after installation and debugging
fault handling	Monday to Sunday	Responding at any time	Minor fault : remote solution Serious fault : reach the scene within 24 hours to solve



美国GE公司



山东大学

SHANDONG UNIVERSITY



新加坡丰益国际



中国水产科学研究院

Chinese Academy of Fishery Sciences



扬子江药业集团

护佑 Yangtze River Pharmaceutical Group



中国科学院化学研究所

INSTITUTE OF CHEMISTRY / CHINESE ACADEMY OF SCIENCES



三九医药



陕西师范大学

SHAANXI NORMAL UNIVERSITY



首钢集团

SHOUGANG GROUP



天津大学

Tianjin University



厦门大学

XIAMEN UNIVERSITY



西藏农牧学院

Tibet Agricultural and Animal Husbandry University



INTEGRATORS OF CRYOGENIC SYSTEM SOLUTION

THANKS!

LDH GAS SYSTEMS COMPANY LIMITED



contact person: LDH GAS SYSTEMS COMPANY LIMITED
Telephone: 010-86482980

mailbox: market@bj-ldh.com
network station: www.bj-ldh.com

| 氮气系统 | 解决问题 集成商
| nitrogen system | Problem-solving Integrator